

**2 PIECE ADJUSTABLE  
BRICK VENEER  
ANCHORING SYSTEM**



U. S. PATENTS #4473984  
#4764069  
CANADA PATENT #1224344

**NO. 75HE POS-I-TIE® ADVANTAGES OVER OTHER SYSTEMS**

1. Pos-I-Tie® Single Screw System fully complies with the ACI 530 Code. The Barrel Screw is 1 piece. No more plates, screws and gaskets. It screws into the backup in seconds.
2. Uses consistent screw. Screw is provided as a part of the POS-I-TIE® System. - No inferior screws can be substituted.
3. Provides positive connections. Screw actually penetrates gypsum board and makes a Positive Lateral Connection with the backup for transfer of compression and tension loads to structural backup.
4. Enables speedy cost-saving installation. Only one screw needs to be placed, not two.
5. Corrosion Resistant. POS-I-TIE® seals the hole it makes when it seats itself in the backup. Barrel section is made of ZAMAC 2, a 92% zinc alloy. Screws are Zinc electro plated, coated twice, and baked in STALGARD®.
6. Slotted Barrel allows for differential movement due to temperature variations. Tie design provides for allowable ACI 530 code vertical adjustment.
7. Allows for use of 4' x 8' insulation sheets. The Pos-I-Tie® holds the insulation in place!

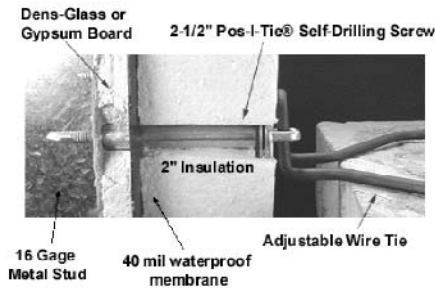

**6 BARREL LENGTHS**

- 5/8" for 1/2" and 5/8" gypsum.
- 1" for 1" insulation.
- 1-1/2" for 1" insulation over gypsum.
- 2" for 2" insulation.
- 2-1/2" for 2" insulation over gypsum.
- 3" for 2-1/2" insulation over gypsum.

Complies with the Energy Conservation Requirements of the Massachusetts State Building Code (780 CMR 13 Envelope).



**3 TYPES OF SCREWS**

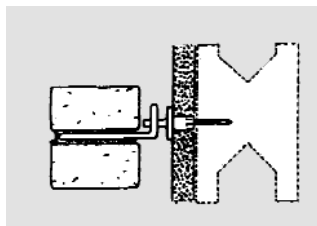

**SELF DRILLING SCREW FOR BRICK VENEER TO STEEL STUDS**

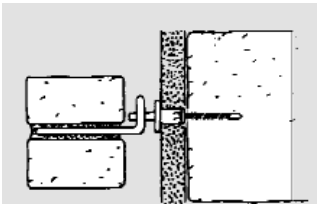

**TAPCON® SCREW FOR BRICK VENEER TO CONCRETE, CMU, WOOD OR BRICK**



Tapcon® Pos-I-Tie® may not be suitable for some hard aggregate concrete

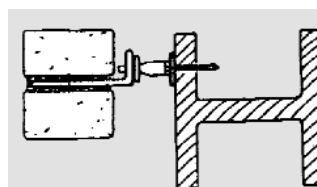

**DRIL-IT® SCREW FOR BRICK VENEER TO STRUCTURAL STEEL**



**Wire Ties**



Triangle Wire Tie



Seismic Wire Tie



Single Wire Tie

Check for Local Code acceptance of the Single Wire Tie

**NEW!** 1/4" (6.35mm) extensions for conditions requiring a double layer of gypsum to increase the R value of wall.

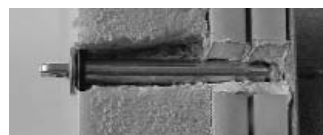
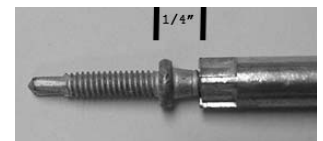

Standard Wire Ties are 3" (76 mm), 3-1/2" (89 mm), 4" (102 mm) and 5" (127 mm) long in 3/16" (4.76 mm) dia. wire Mill Galv., Hotdip Galv., or Stainless Steel. Special lengths are available.